

# CONCEPTUAL PLAN

## SOUTHERN NEVADA VETERANS MEMORIAL CEMETERY

BOULDER CITY, CLARK COUNTY, NEVADA  
JUNE 2019

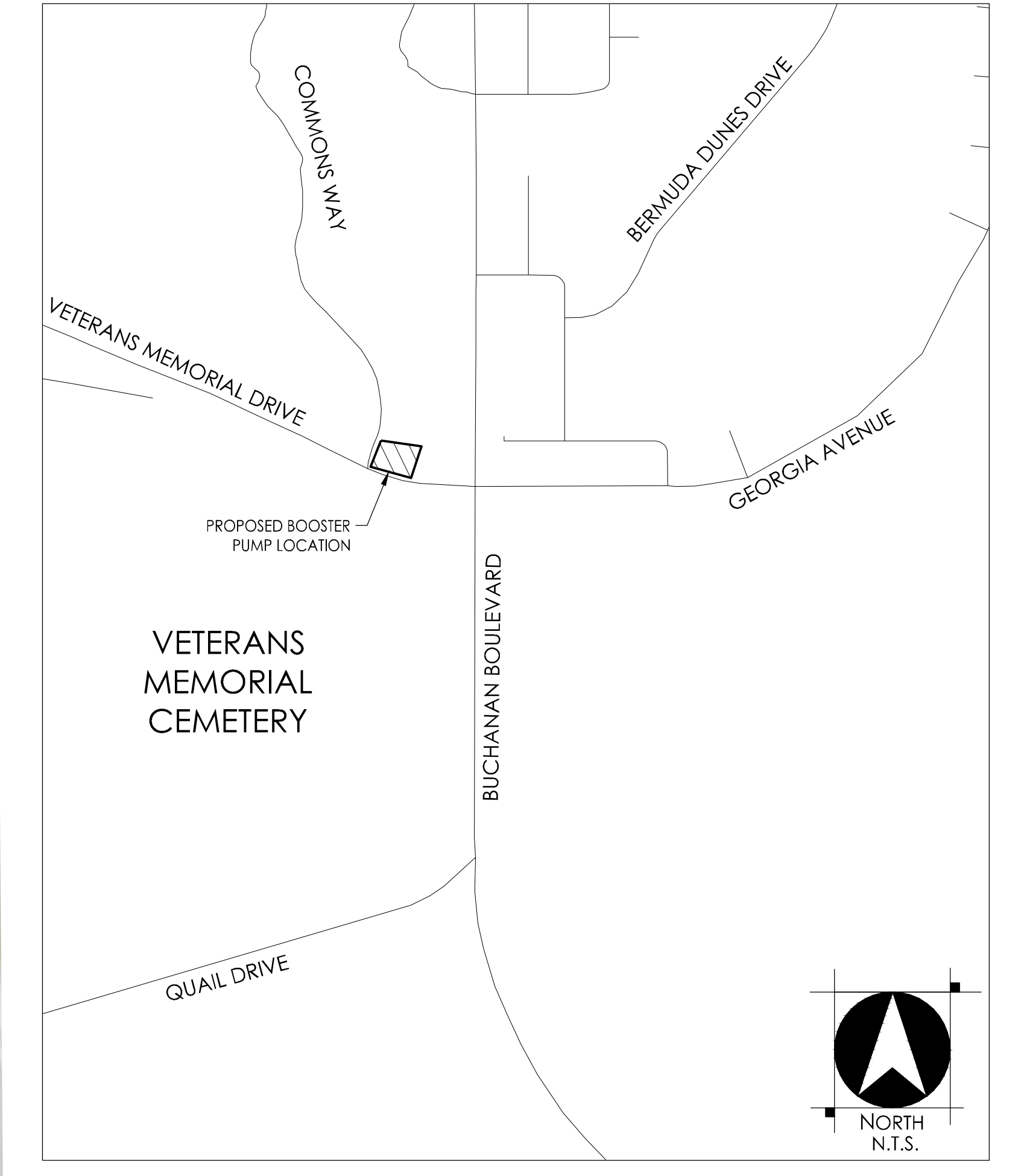
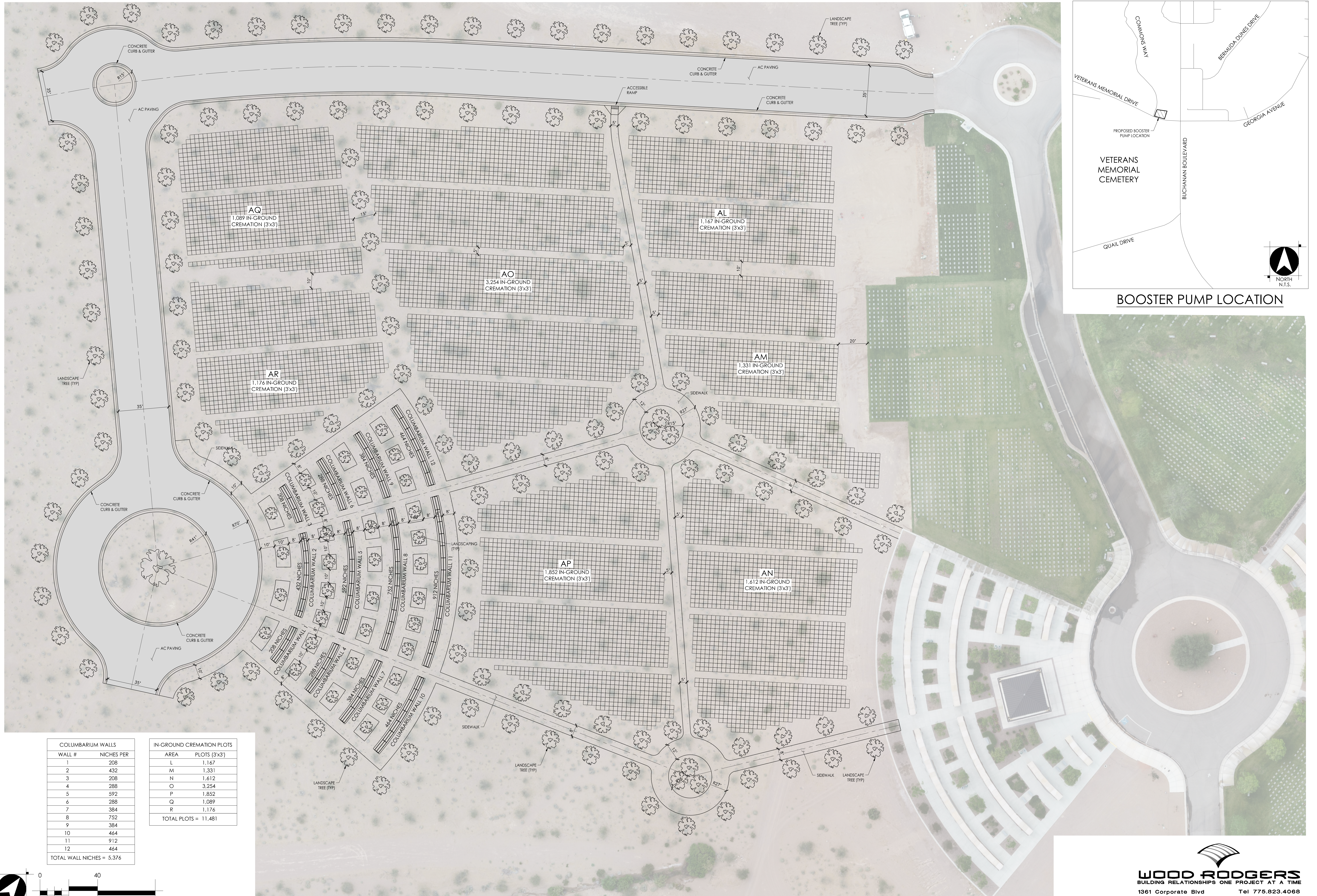

**BOOSTER PUMP LOCATION**

COLUMBARIUM WALLS	
WALL #	NICHES PER
1	208
2	432
3	208
4	288
5	592
6	288
7	384
8	752
9	384
10	464
11	912
12	464
TOTAL WALL NICHES = 5,376	

IN-GROUND CREMATION PLOTS	
AREA	PLOTS (3x3)
L	1,167
M	1,331
N	1,612
O	3,254
P	1,852
Q	1,089
R	1,176
TOTAL PLOTS = 11,481	

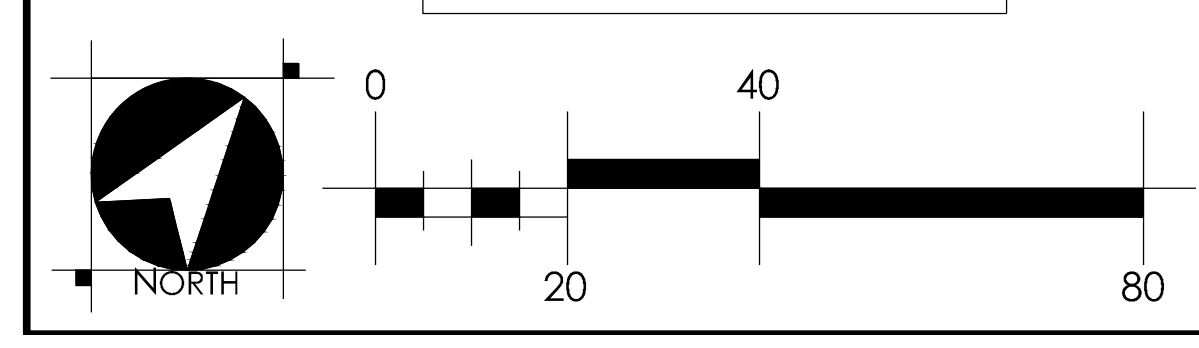

**WOOD ROGERS**  
BUILDING RELATIONSHIPS ONE PROJECT AT A TIME

1361 Corporate Blvd Reno, NV 89502 Tel 775.823.4068 Fax 775.823.4066

S:\Projects\2019\Veterans\_Memorial\_Cemetery\DW\Planning\Architect\Site\36446\_SNVMC\_210.dwg 07/27/2019 8:38 AM Gus Hubbard